

S:\AFMMachines\19050 Light Touch Buttons\

ITEM NO.	QTY.	DESCRIPTION	PartNo	PART NUMBER
1	1	Switch Plate	104717	19050-002
2	1			PBCircuitBreaker
3	2	2522 Nut		2522 Nut
4	2	Strain Relief T&B	2522	2522
5	1	Button Bar	104716	19050-001
6	1	Blank Plate	104718	19050-003
7	2	Button, Optical Touch, 10-30 VDC	OTBVN6	OTBVN6
8	2	Button, Optical Touch, Hood	Comes with OTBVN6	OTBVN6 Hood
9	2	End Cap	104719	19050-004

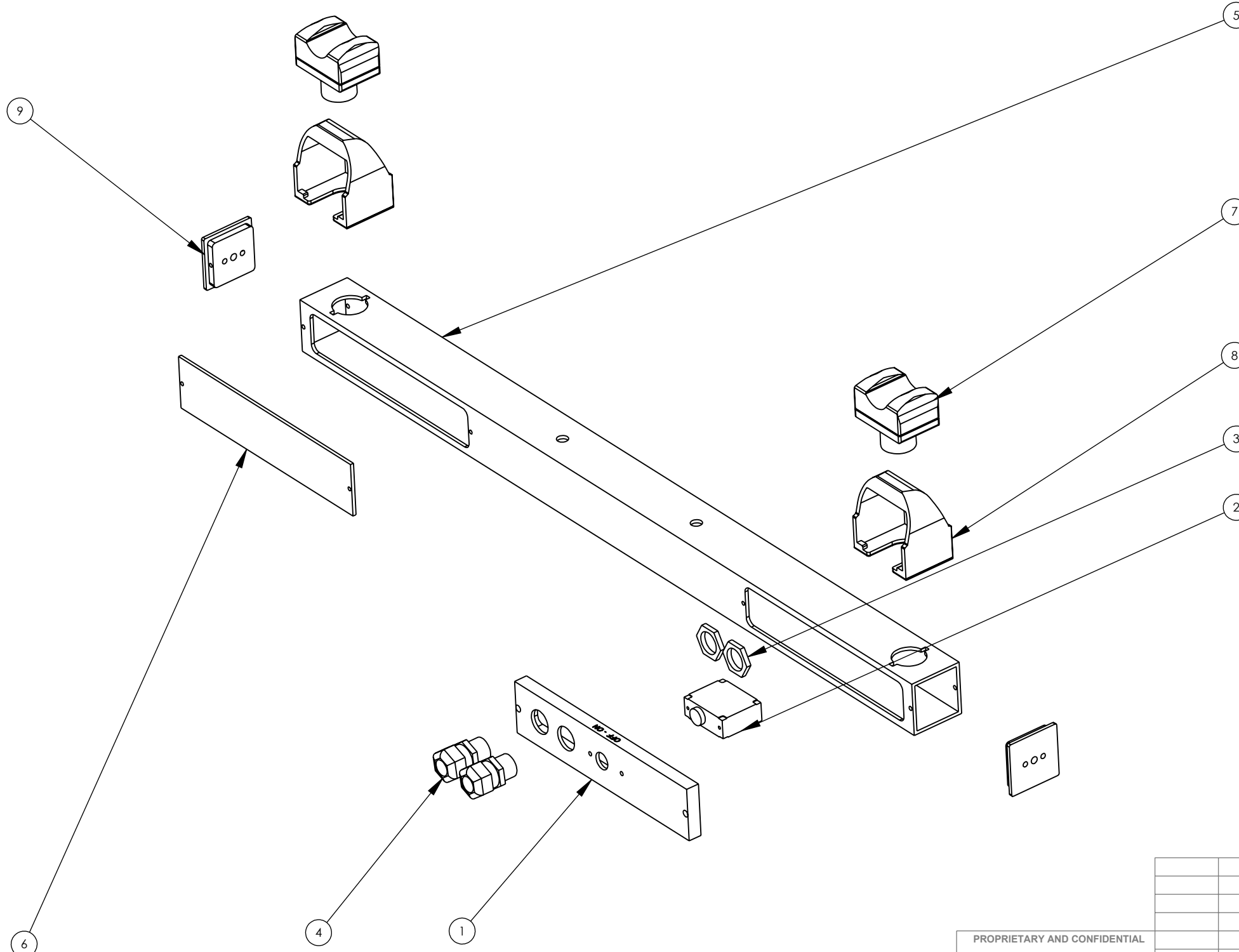

**PROPRIETARY AND CONFIDENTIAL**  
 THE INFORMATION CONTAINED IN THIS DRAWING IS THE SOLE PROPERTY OF AFM ENGINEERING, INC. ANY REPRODUCTION IN PART OR AS A WHOLE WITHOUT THE WRITTEN PERMISSION OF AFM ENGINEERING INC. IS PROHIBITED.

DIMENSIONS ARE IN INCHES		NAME	DATE	
TOLERANCES:		DRAWN	Irwin	2/10/2006
FRACTIONAL		CHECKED	Irwin	2/10/2006
ANGULAR: MACH BEND		ENG APPR.		
TWO PLACE DECIMAL .010		MFG APPR.		
THREE PLACE DECIMAL .005		Q.A.		
MATERIAL		COMMENTS:		
NEXT ASSY	USED ON			
FINISH				
APPLICATION		DO NOT SCALE DRAWING		

AFM Engineering, Inc.		
AFM Engineering inc.		
Light Touch Palm Button Bar		
AFM PART # 103207		
SIZE	DWG. NO.	REV.
B	19050-000	
SCALE: 1:1	WEIGHT: 5.693	SHEET 1 OF 1